

214C INDUSTRIAL SOLENOIDS

SPECIFICATIONS

- ☆ 1/4" to 3/8" NPT Solenoids
- ☆ Watts: 12 A.C.
- ☆ VA Inrush / Holding: 44 / 22
- ☆ M.W.P. 350 psi
- ☆ Minimum Operating Pressure Differential: 2 psi
- ☆ Pilot Operated: 2 to 200 P.S.I.
- ☆ CSA file number: LR3204
- ☆ UL file number: MP604
- ☆ CRN file number: OC0824.9 (see page A)

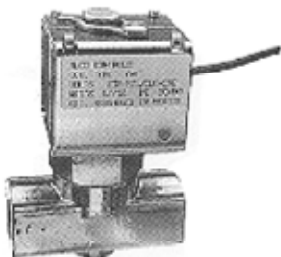

Coil sold separately see page 36 of Catalogue.

EXPLODED VIEW 214C

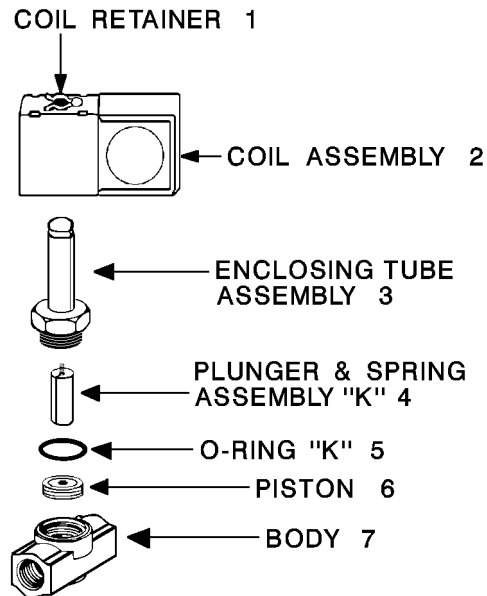

214C VALVE REPAIR KITS

SEAT MATERIAL	KIT #	PCN
Buna-N	K-1112	035074
Ethylene Propylene	K-1113	041334

214C SELECTION & ORDERING INFORMATION

PIPE SIZE	ORIFICE SIZE	M.O.P.D. ^③	Cv	MAX. AC FLUID TEMP. ^③	COIL CODE ^①			CATALOG NUMBER ^②	PCN*	ELASTOMER
		AC			SIZE	INSULATION	ENCLOSURE			
BRASS GENERAL PURPOSE										
1/4	1/4	200	1.2	180°F	A	M	G	214CB1/4B1/4B	030540	BUNA-N
	5/16	200	1.6		12 Watts			214CB1/4B5/16B	030541	
	3/8	200	2.2		AC	Class F	Junction Box	214CB1/4B3/8B		
3/8	1/4	200	1.2		Molded			214CB3/8B1/4B		
	5/16	200	1.6					214CB3/8B5/16B		
	3/8	200	2.2					214CB3/8B3/8B	030545	

① Unless otherwise specified, Junction Box will be supplied as standard. Refer to table below for available coil options.

* Product Code Number

② Refer to tables below for options.

③ With an ambient temperature of 77°F.

④ Maximum Operating Pressure Differential.

NOTE: Minimum Operating Pressure Differential is 2 psi.